

REV.	MARK	ECN NO.	MODIFY DES.	DR.	DATE
A		1st. Release		Ivy Hsu	07/02/2007
B			REVISE P/N	Ivy Hsu	09/19/2007

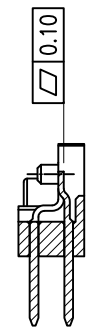

SECTION A-A

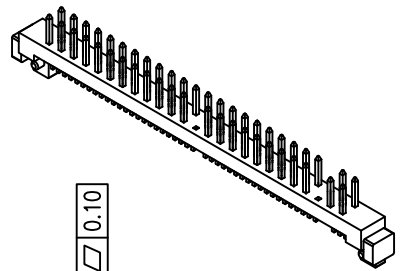
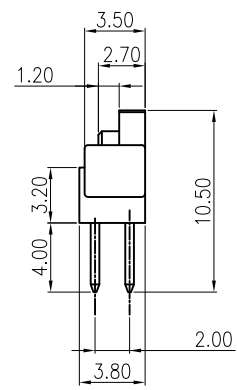
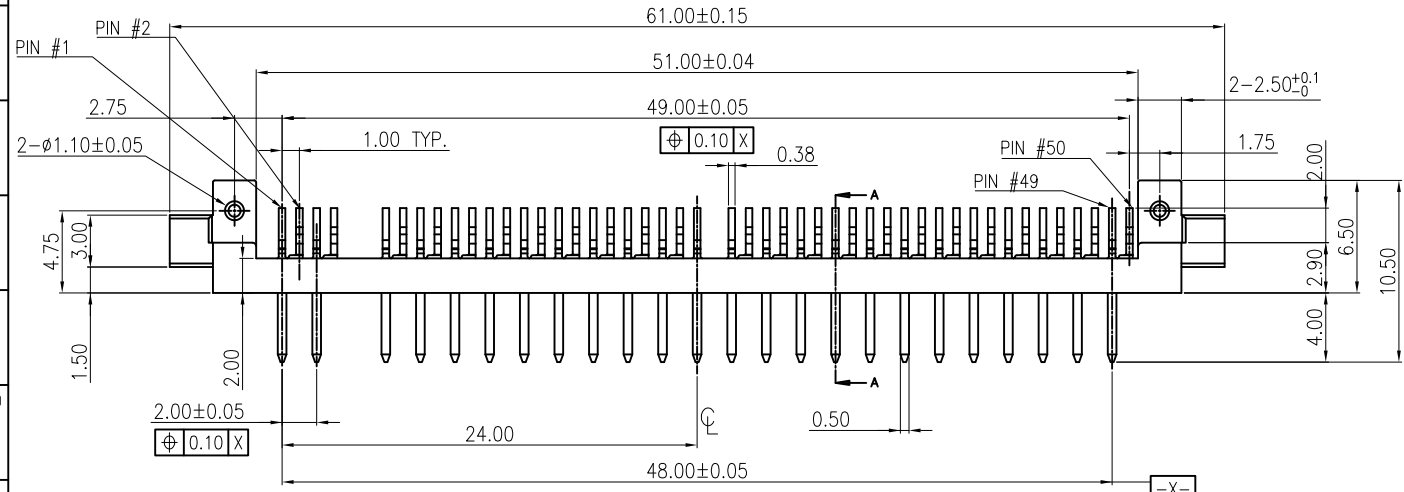
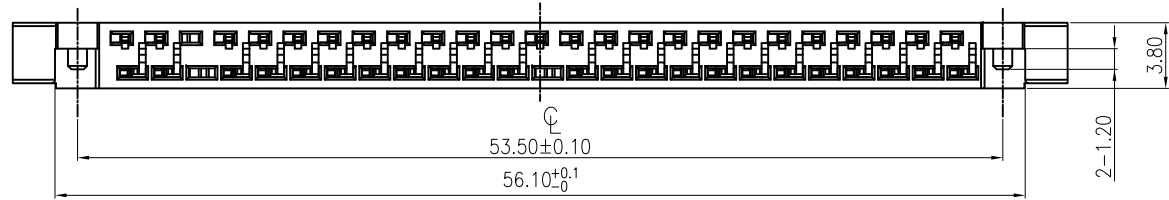
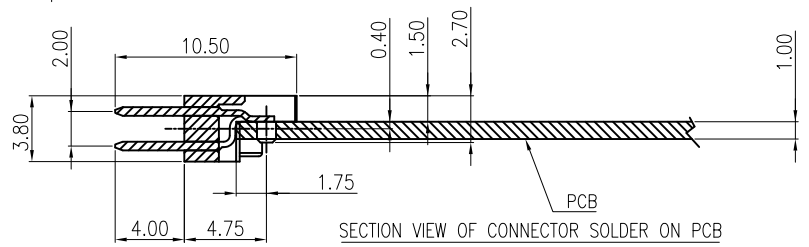
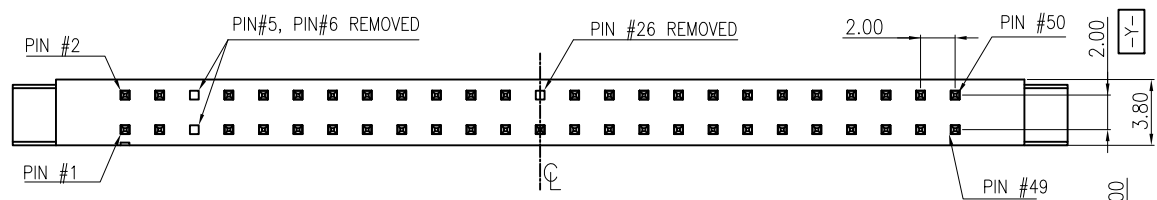

SECTION VIEW OF CONNECTOR SOLDER ON PCB

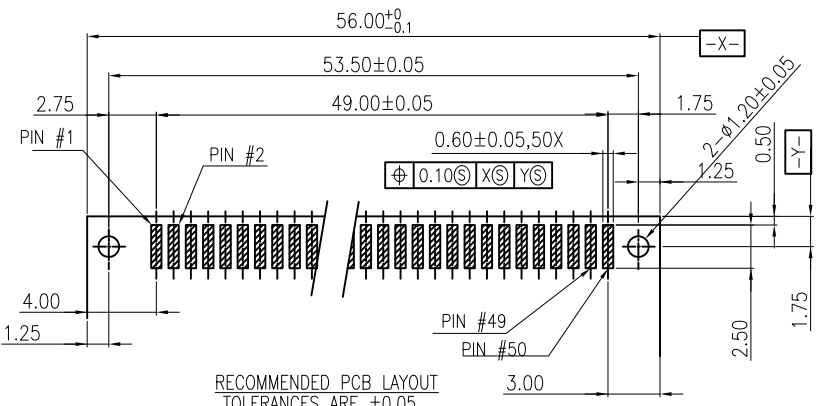

RECOMMENDED PCB LAYOUT  
TOLERANCES ARE ±0.05

- NOTES:
- MATERIAL & FINISH  
HOUSING: LCP WITH 30% GLASS FIBER FILLED, UL94V-0 RATED  
COLOR IN BLACK  
CONTACT: COPPER ALLOY, 10" GOLD PLATED ON CONTACT AREA,  
120u" MIN. TIN PLATED ON SOLDER TAIL, 50u" MIN. NICKEL  
UNDERPLATE OVER ALL
  - ROHS COMPLIANT
  - TRAY PACKING

DWG NO.		APPROVAL			
13912-ATG030		ATERGI TECHNOLOGY CO., LTD.			
P/N 139540-AOATG110		APPD: Lung	TITLE: 50PIN IDE CONNECTOR 2.0 MM PITCH		
DRAFT WHERE APPLICABLE MUST REMAIN WITHIN DIMENSIONS TOLERANCES		CHKD:	DR: IVY HSU	SCALE: NONE	UNITS: mm
X ± 0.38	X' ± 3"	DR: IVY HSU	SCALE: NONE	UNITS: mm	
XX ± 0.25	XX' ± 2"	REV. B	SHEET: 1 OF 1	DATE: 07/02/2007	
XXX ± 0.20	XXX' ± 1"				