

| REV. | MARK | ECN NO. | MODIFY DES. | DR. | DATE |
|------|------|---------|-------------|---------|------------|
| A | | | | Ivy Hsu | 07/19/2007 |
| B | △ | | | Ivy Hsu | 12/27/2007 |

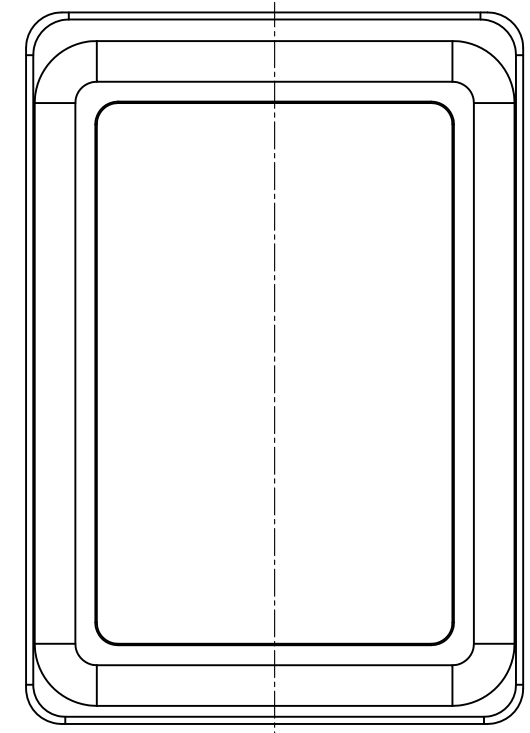
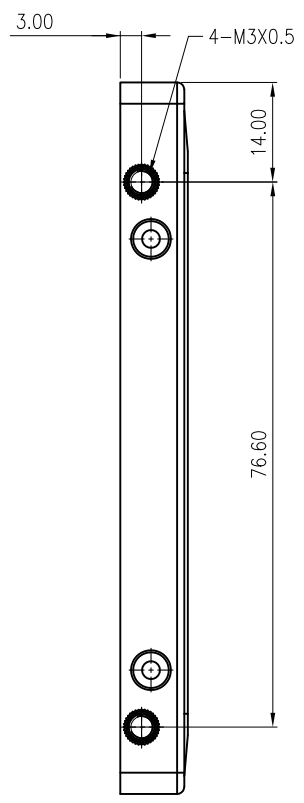
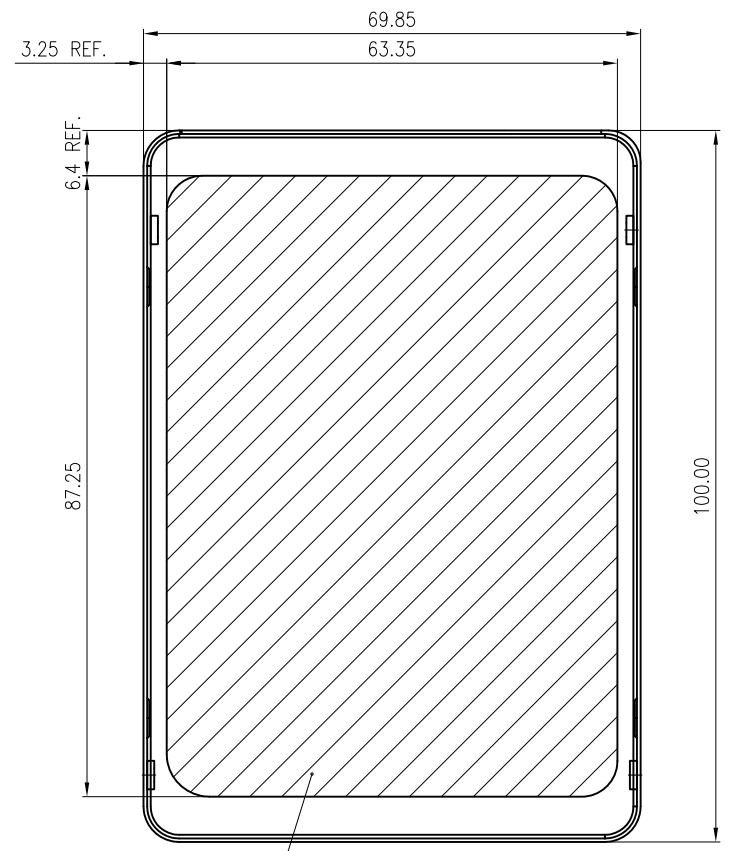
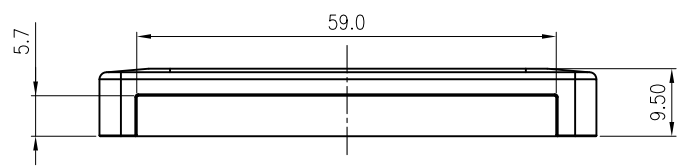

- NOTE:
1. MATERIAL: STAINLESS STEEL 0.5MM THICKNESS
 2. MYLAR: PET, TRANSPARENT
 3. RoHS COMPLIANT
 - △ 4. OTHER TOLERANCES ARE ± 0.15 MM

| | | | | | |
|---|-----------------|-----------------------------|-----------------------------------|------------------|--|
| DWG NO. | 15498-ATG030 | ATERGI TECHNOLOGY CO., LTD. | | | |
| P/N | 15410-00ATG3010 | APPD: Lung | TITLE: TOP COVER ASSEMBLY FOR IDE | | |
| DRAFT WHERE APPLICABLE MUST REMAIN WITHIN DIMENSIONS TOLERANCES | | CHKD: | | | |
| X ± | X' ± | DR: Ivy Hsu | SCALE: 1 : 1 | UNITS: mm | |
| XX ± 0.25 | XC ± 10' | | SHEET: 1 OF 1 | DATE: 07/19/2007 | |
| XXX ± 0.15 | XX' ± 5' | REV. B | | | |
| XXXX ± 0.05 | XXX' ± 1' | | | | |